

Overview

Each pump is built with a controller factory set for a bar pressure start up meaning it maybe set at 0.5bar so when pressure is released In the system the pump wont start until it drops past 0.5bar.

This can cause delays to water at the taps on multi story set ups or set ups with long runs of pipework.

As every set up is different the controller may need adjusting to suit your particular set up to allow water to come on as fast as possible.

To do this follow the instructions below but you **MUST** ensure the power has been disconnected to the pump to ensure yours or someone else's safety.

Once you've turned the start up pressure up to as an example say 2 bar then the pump will come on a lot sooner after taps are opened as the drop in pressure would be quick.

If this doesn't resolve the issue then there could be a breakdown in the pressure switch or the set up maybe to big for the particular pumps capabilities. If this is so please call our office on 0800 7310589 to find a solution to the water delay.

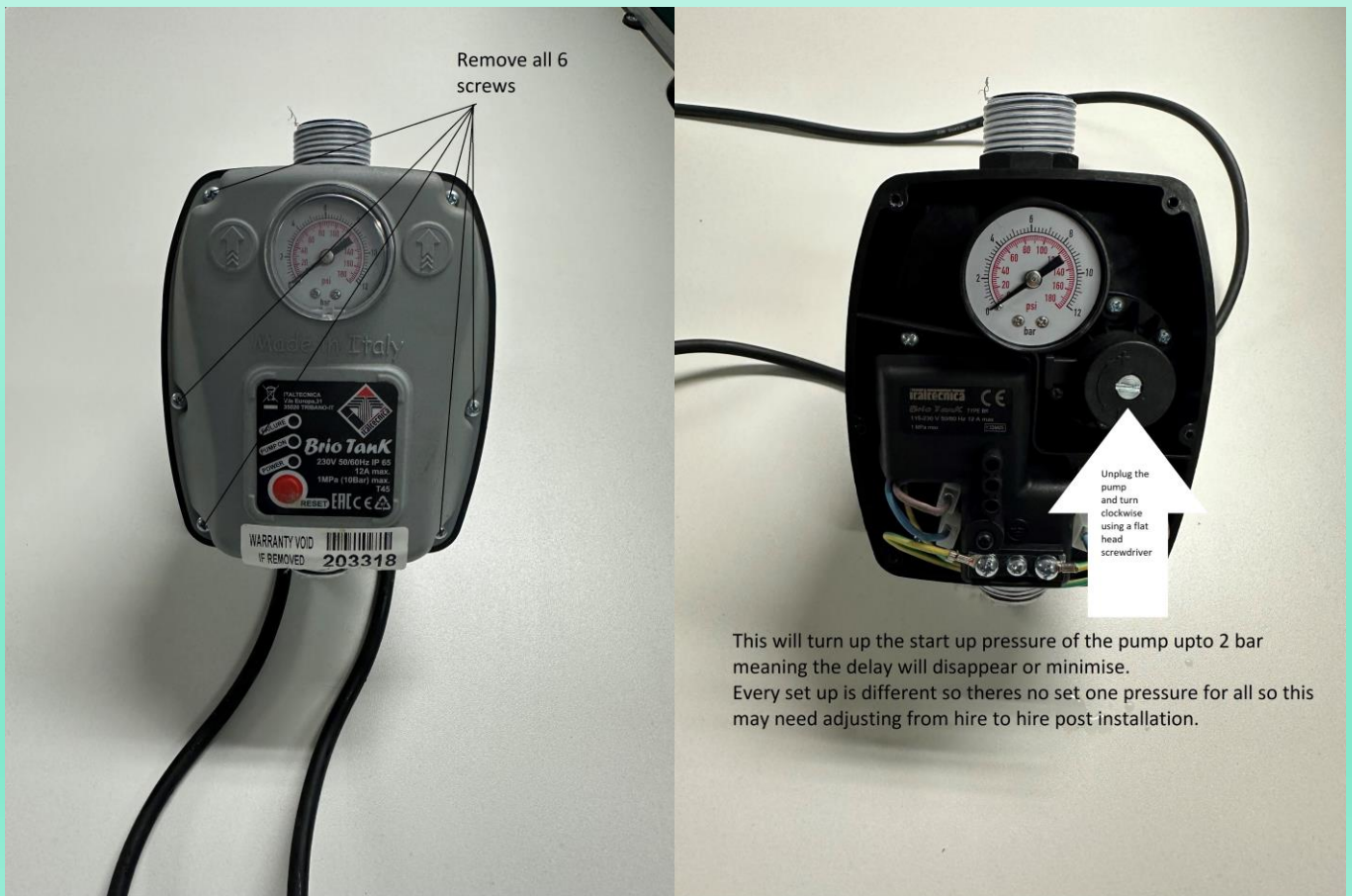

This will turn up the start up pressure of the pump upto 2 bar meaning the delay will disapear or minimise. Every set up is different so theres no set one pressure for all so this may need adjusting from hire to hire post installation.